

Totem Table Mini Assembly Guide

Pablo®

PAGE 1/2

CAUTION - We recommend this fixture be installed by a licensed Electrician.

Before assembling and installing this product, carefully read the following:

- When installing multiple lamps; these fixtures must be wired in parallel in order to achieve the best possible light quality from each lamp. Wiring in series will result in the progressive loss of performance as the lamps move further away from the building power.
- Switch off power to the junction box before installing the lamp.
- Move light switch into the OFF position.
- When mounting to the ceiling, always use appropriate anchoring hardware.
- This lamp has an IP44 Damp Rating; suitable for indoor use including most humid and damp areas such as bathrooms.
- We recommend reading the guide before you begin installation.
- Installation Guides can be downloaded from Pablodesigns.com in the case this document is lost or damaged.
- Do not disassemble, modify or try to repair this fixture! In order to receive technical assistance contact Pablo Designs. Any modification to the fixture will nullify the manufacturer's warranty.

IMPORTANT INFORMATION ABOUT MATERIALS/FINISHES:

- Glass is a material which is fragile and can be easily damaged when mishandled.
- One of the main characteristics of Opal glass is that it is hand blown. Small imperfections like; air bubbles, thickness variations, or scratches can occur during the production process. These imperfections underline the craftsmanship, the exclusivity and authenticity of hand blown Opal glass.

CLEANING INSTRUCTIONS:

- Use only a soft cloth to clean this fixture, dampened with water or mild cleanser if required, DO NOT use alcohol, solvents, or other abrasive cleaners, as this could damage the lamp finish.

TECHNICAL SPECIFICATIONS

High Output LED ARRAY
hand-blown glass shades
18 Watt
2700-2200 DTW
1800 Lumens

Contents

TOTEM MINI SHIPS IN MULTIPLE BOXES IN ORDER TO ENSURE THE SAFETY OF ALL COMPONENTS.

A. LED LAMP ASSEMBLY + DIMMER + POWER SUPPLY

B. TOTEM MINI E SHADE

C. TOTEM MINI E SHADE

D. LAMP FEET (3)

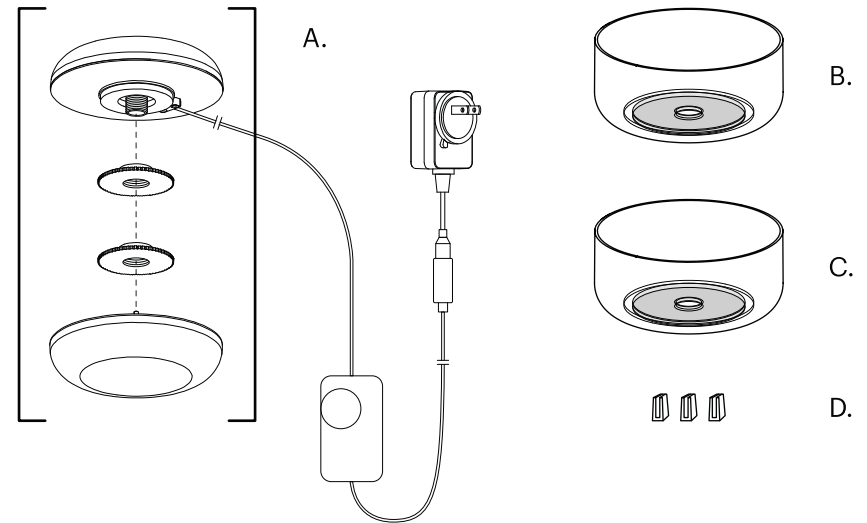

IF THERE ARE MISSING OR DAMAGED PARTS, PLEASE CONTACT US AS SOON AS POSSIBLE TO FILE A REPORT. CLEAR PHOTOS AND DESCRIPTIONS WILL ENABLE OUR CUSTOMER SERVICE TEAM TO QUICKLY AND EFFECTIVELY ADDRESS YOUR CLAIM.

(415) 865-5000
888 MARIN STREET
SAN FRANCISCO, CA 94124
INFO@PABLODESIGNS.COM
[\[INFO@PABLODESIGNS.EU\]](mailto:INFO@PABLODESIGNS.EU)

Totem Table Mini Assembly Guide

Pablo®

PAGE 2/2

- 1** Unthread all components of the LED LAMP ASSEMBLY (4 PARTS).

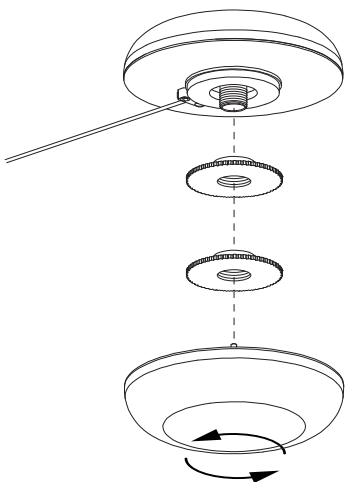

- 2** Secure the BOTTOM SHADE to the LED + DIMMER subassembly using the SHADE COUPLER.

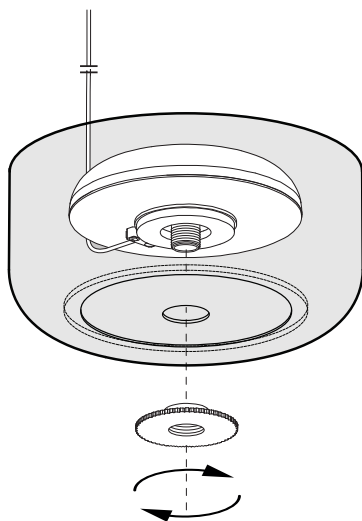

- 3** Secure the TOP SHADE to the bottom SHADE using the second SHADE COUPLER.

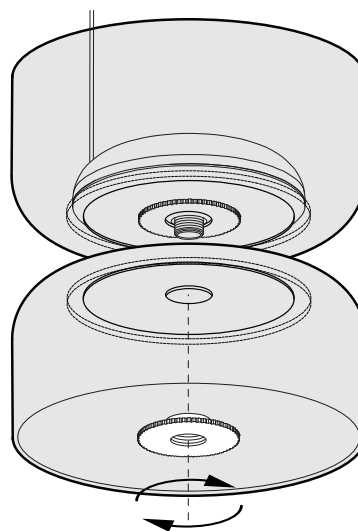

- 4** Thread the LED MODULE onto the lamp assembly.

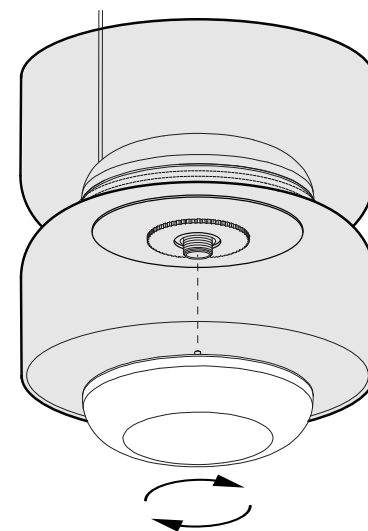

- 5** Place LAMP FEET onto the rim of the BOTTOM SHADE. Ensure feet are equally spaced.

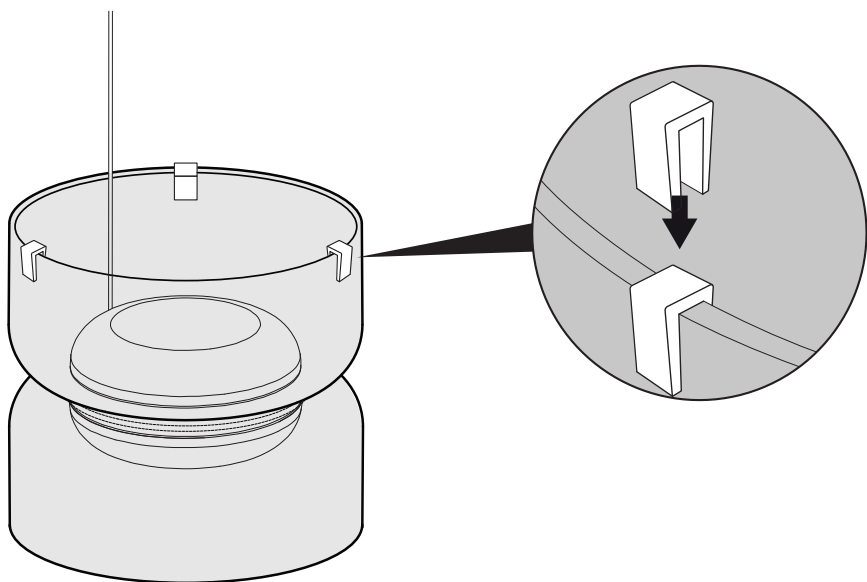

- 6** Carefully flip the assembled lamp so that the FEET are contacting the table surface.

